

HARBOURFRONT REFINEMENT

Soaring over Victoria Harbour in Kowloon, Rosewood Hong Kong is the crown jewel of the Victoria Dockside arts and design district. Expressing the city's dynamism, cultural vibrancy and modernity, the design of this landmark ultra-luxury hotel exudes a gracious lifestyle within the elegant, vertical estate. It features majestic views of Victoria Harbour and Hong Kong Island, verdant landscaping, impeccably detailed interiors by Tony Chi and the first urban outpost of Asaya, the Rosewood Hotels and Resorts® signature integrative wellness concept. Accommodations, amongst the most spacious in Hong Kong, include 18 specialty suites, some with sky gardens, private pools and fitness facilities. Impressive event venues include The Pavilion, which features soaring windows and its own private terrace with harbour views and state-of-the-art technology, in Rosewood's signature, elevated high-residential style.

MEETING & FUNCTION SPACES

3,200 SQ. M.

(33,880 sq. ft.)

ACCOMMODATING

UP TO

2,000 GUESTS.

THE PAVILION

920 SQ. M.

(9,900 sq. ft.)

ACCOMMODATING

UP TO

600 GUESTS.

Meetings & Events

LOCATION

Conveniently situated on the Kowloon harbour-front, on a historic site where the city's future as a global trading hub was first established, and framed within the ambitious Victoria Dockside arts and design district, Rosewood Hong Kong is an icon for the city. The hotel is connected to Hong Kong Island by quick, convenient water, road, MTR, and Star Ferry transfers.

MEETINGS & EVENTS

Rosewood Hong Kong's event facilities unveil some of Hong Kong's most expansive, distinguished meetings and events space enhanced by artfully landscaped gardens with immersive harbour views totalling 3,200 Sq. M. (33,880 Sq. Ft.).

The Grand Ballroom features 1,000-Sq.-M. (10,700-Sq.-Ft.) of pillarless event space, with a dramatic "skyfold" automated partition to offer limitless versatility. Reflecting the vision for the vertical estate, eight daylit multi-purpose Meeting Salons include show kitchens and living rooms, with verdant surrounds including the Lawn, overlooking the harbour.

THE PAVILION

Situated on the fourth floor of the hotel, The Pavilion offers 920 Sq. M. (9,900 Sq. Ft.) of superlative, residential-style event space. Three versatile meeting rooms can accommodate up to 260 guests and offer a meticulously designed private show kitchen and adjoining living rooms.

Overlooking Victoria Harbour, the 300-Sq.-M. (3,122-Sq.-Ft.) fourth floor Pavilion Hall features an 80-Sq.-M. (860-Sq.-Ft.) pre-function area, making it the perfect setting for refined events catering to up to 250 guests. For the ultimate bespoke event experience, the 180-Sq.-M. (1,990-Sq.-Ft.) Orangery caters to both bridal and exclusive event showcases, featuring a dramatic carved limestone grand staircase which connects it to the third-floor function rooms and a landscaped private outdoor terrace with breezy water views.

EVENT STUDIO

The Event Studio is a visual showcase of Rosewood Hong Kong's nuanced and wide-ranging event capabilities. Showcasing an exclusive collection of event accessories illuminated by natural daylight, the Event Studio is the perfect canvas on which to brainstorm with our specialists to create bespoke table styling, floral and gourmet menus to suit your most exacting requirements.

CUISINE

Each meeting and event experience at Rosewood Hong Kong is an exquisite sensory journey-in-the-making. Our talented culinary team has created sophisticated menus featuring an array of traditional regional Chinese, pan-Asian and European-inspired delights. Rosewood's signature events deliver attentive service and tastes for all types of gatherings, from intimate dinners to receptions and banquets for up to 1,000 guests.

CAPACITY CHART

| | <i>sq. m.</i> | <i>sq. ft.</i> | <i>height (m / ft)</i> | <i>size (m)</i> | <i>reception</i> | <i>banquet</i> | <i>cabaret</i> | <i>theatre</i> | <i>classroom</i> | <i>u-shape</i> | <i>boardroom</i> |
|---------------------------------|---------------|----------------|------------------------|-----------------|------------------|----------------|----------------|----------------|------------------|----------------|------------------|
| <i>3rd Floor — Event Spaces</i> | | | | | | | | | | | |
| GRAND BALLROOM | 1000 | 10700 | 7.2 / 23.6 | 40 X 25 | 800 | 780 | 480 | 1050 | 540 | N/A | N/A |
| GRAND BALLROOM SOUTH | 304 | 3272 | 7.2 / 23.6 | 13 X 25 | 250 | 195 | 120 | 330 | 150 | N/A | N/A |
| GRAND BALLROOM NORTH | 668 | 7190 | 7.2 / 23.6 | 27 X 25 | 500 | 468 | 288 | 704 | 324 | N/A | N/A |
| PRE-FUNCTION AREA | 188 | 2024 | 3.3 / 10.8 | 27 X 7 | 100 | N/A | N/A | N/A | N/A | N/A | N/A |
| FOYER | 220 | 2358 | 3.3 / 10.8 | 21 X 10 | 200 | N/A | N/A | 210 | N/A | N/A | N/A |
| THE LAWN | 180 | 1938 | N/A | 7 X 25 | 120 | N/A | N/A | 96 | N/A | N/A | N/A |
| VICTORIA SUITE | 82 | 882 | 3.3 / 10.8 | 17 X 6 | 15 | 10 | N/A | N/A | N/A | N/A | N/A |
| <i>The Galleries</i> | | | | | | | | | | | |
| GALLERY 301 | 58 | 624 | 3.3 / 10.8 | 8 X 8 | 40 | 26 | 16 | 30 | 27 | 18 | 18 |
| GALLERY 302 | 126 | 1346 | 3.3 / 10.8 | 14 X 9 | 120 | 91 | 56 | 110 | 72 | 45 | 36 |
| GALLERY 303 | 76 | 818 | 3.3 / 10.8 | 12 X 7 | 60 | 39 | 24 | 54 | 36 | 30 | 24 |
| GALLERY 304 | 74 | 808 | 3.3 / 10.8 | 13 X 6 | 60 | 52 | 32 | 60 | 36 | 33 | 30 |
| GALLERY 301-302 | 184 | 1969 | 3.3 / 10.8 | 22 X 8 | 160 | 117 | 72 | 140 | 99 | 60 | 60 |
| GALLERY 302-303 | 202 | 2161 | 3.3 / 10.8 | 26 X 7 | 180 | 130 | 80 | 132 | 99 | 78 | 72 |
| GALLERY 301-303 | 260 | 2782 | 3.3 / 10.8 | 34 X 8 | 250 | 156 | 96 | 164 | 126 | 96 | 96 |
| <i>4th Floor — The Pavilion</i> | | | | | | | | | | | |
| THE PAVILION HALL | 300 | 3122 | 3.6 / 11.8 | 25 X 12 | 200 | 160 | 128 | 222 | 60 | 36 | 35 |
| PAVILION HALL FOYER | 80 | 860 | 3.3 / 10.8 | 13 X 8 | 80 | N/A | N/A | N/A | N/A | N/A | N/A |
| <i>The Salons</i> | | | | | | | | | | | |
| SALON I | 100 | 1076 | 3.6 / 11.8 | 12 X 8 | 60 | 50 | 40 | 80 | 24 | 22 | 20 |
| SALON II | 160 | 1734 | 3.6 / 11.8 | 13 X 9 | 120 | 80 | 64 | 120 | 36 | 28 | 27 |
| SALON III | 30 | 325 | 3.3 / 10.8 | 6 X 5 | 10 | N/A | N/A | N/A | N/A | N/A | N/A |
| SALON IV | 90 | 980 | 3.3 / 10.8 | 10 X 7 | 60 | 32 | 20 | 48 | 12 | 16 | 15 |
| THE ORANGERY | 185 | 1990 | 3 / 9.8 | 24 X 7 | 60 | 20 | N/A | N/A | N/A | N/A | N/A |

FLOOR PLANS

3RD FLOOR

EVENT SPACES

The Rosewood Grand Ballroom is a luxurious and flexible venue designed for a variety of occasions, featuring carved limestone panelling and a dramatic statement “skyfold” partition feature, as well as a spacious pre-function foyer and standalone bar, adjacent to The Lawn with magnificent al fresco harbour views. All four Galleries feature natural daylight and are equipped with the latest state-of-the-art technology to facilitate seamless meetings and presentations. With corporate planners in mind, a VIP lounge is also available upon request.

- 1 | GRAND BALLROOM
- 2 | THE LAWN
- 3 | GALLERY 301
- 4 | GALLERY 302
- 5 | GALLERY 303
- 6 | GALLERY 304

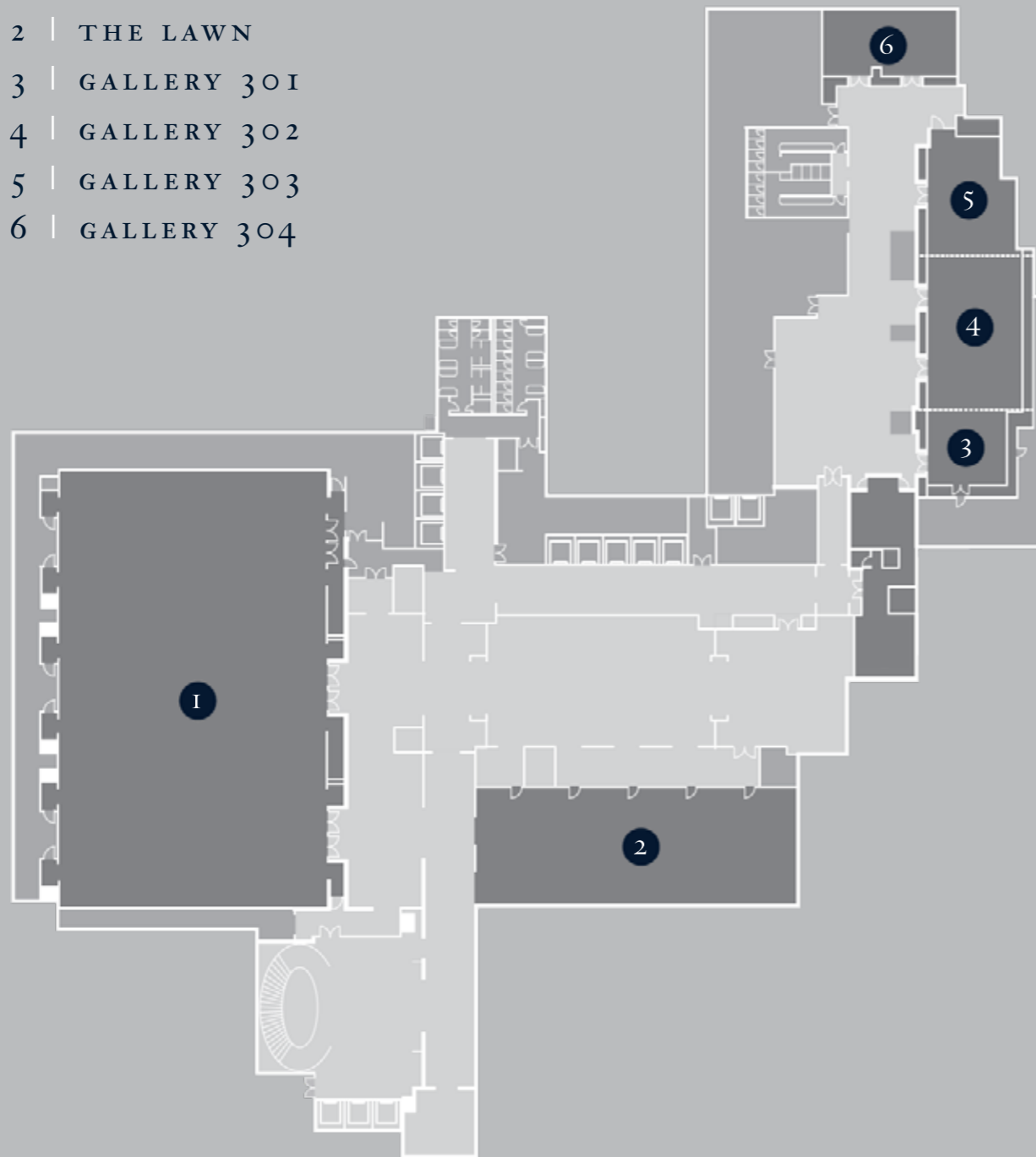

4TH FLOOR

THE PAVILION

The Pavilion offers detail-oriented, flexible event space designed to reflect the ambiance of a luxurious residence. Three multi-purpose Salons can accommodate up to 260 guests and offer a meticulously designed private show kitchen and adjoining living rooms. The Event Studio is the ultimate showcase for you to visualise your event. Natural daylight highlights exclusive event accessories and the full array of Rosewood Hong Kong's superlative signature wedding and event solutions.

- 1 | THE PAVILION HALL
- 2 | THE ORANGERY
- 3 | SALON I
- 4 | SALON II
- 5 | SALON III
- 6 | SALON IV

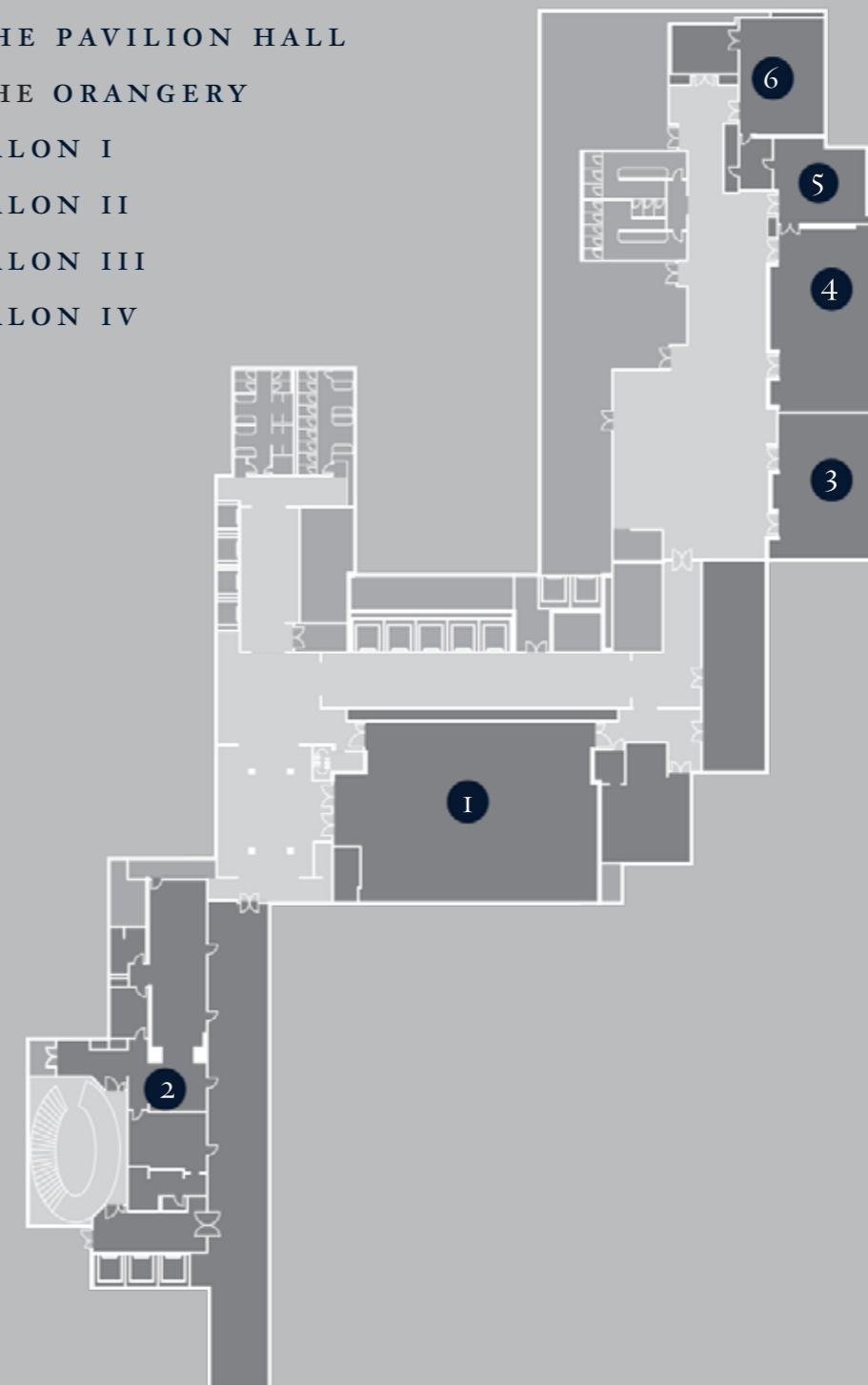

FOR MORE INFORMATION,
PLEASE CONTACT OUR EVENT CONSULTANTS.
TEL: +852 3891 8888 | FAX: +852 3891 8000
EMAIL: HONGKONG.EVENTS@ROSEWOODHOTELS.COM

rosewoodhotels.com/hongkong

香港瑰麗酒店
ROSEWOOD
HONG KONG